

# WARING PRO™

## PROFESSIONAL CORDLESS WINE OPENER

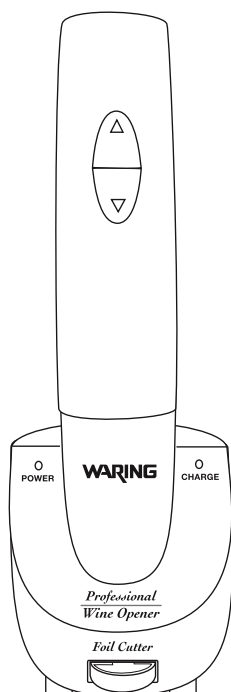

WO50

For your safety and continued enjoyment of this product,  
always read the instruction book carefully before using.

# IMPORTANT SAFEGUARDS

When using electrical appliances, basic safety precautions should always be followed including the following:

## WARNING

1. Do not operate wine opener with a damaged cord or plug, after the appliance malfunctions or if it has been dropped or damaged in any manner. Return appliance to the nearest Authorized Service Center or phone Waring Customer Service at 800 492-7464 for examination, repair or electrical or mechanical adjustment.
2. To protect against risk of electrical shock, do not put the electric wine opener in water or other liquid. This may cause personal injury and/or damage to the product.
3. To protect against fire, do not operate the unit in the presence of explosive and/or flammable fumes.
4. Do not use the electric wine opener for other than intended use.
5. This product is intended for normal domestic household use only.
6. When using or recharging the electric wine opener keep your workspace clean and free from potential hazards.
7. For indoor use only. Do not expose the electric wine opener or charging unit to rain or other extreme conditions.
8. Never force the electric wine opener onto a bottle or attempt to speed up the mechanism. The electric wine opener will work best when it is operated at its intended speed.
9. Do not touch or adjust the electric wine opener's mechanism or the corkscrew spiral. Hold the electric wine opener by its rubberized housing only.
10. Do not attempt to open bottles if the switch is not working correctly.
11. Do not attempt to open the electric wine opener or the recharging base. It has no serviceable parts. Charge the electric wine opener only by using the recharging base and power cord supplied.
12. Never remove the plug from the socket by pulling the power cord.

13. Use of attachments not recommended or sold by Waring may cause fire, electrical shock, injury or damage to the product.

**CAUTION:** Corkscrew is sharp. Handle carefully. Keep hands and utensils out of the container while operating to prevent the possibility of severe personal injury and/or damage to the product or property.

## **SAVE THESE INSTRUCTIONS**

Before you use this product for the first time, please take a few moments to read these instructions. Keep them for future reference.

## PARTS

1. Rubberized handset
2. Power Up/Down switch
3. Power indicator light
4. Charge indicator light
5. Charging base
6. Foil cutter
7. Power adapter

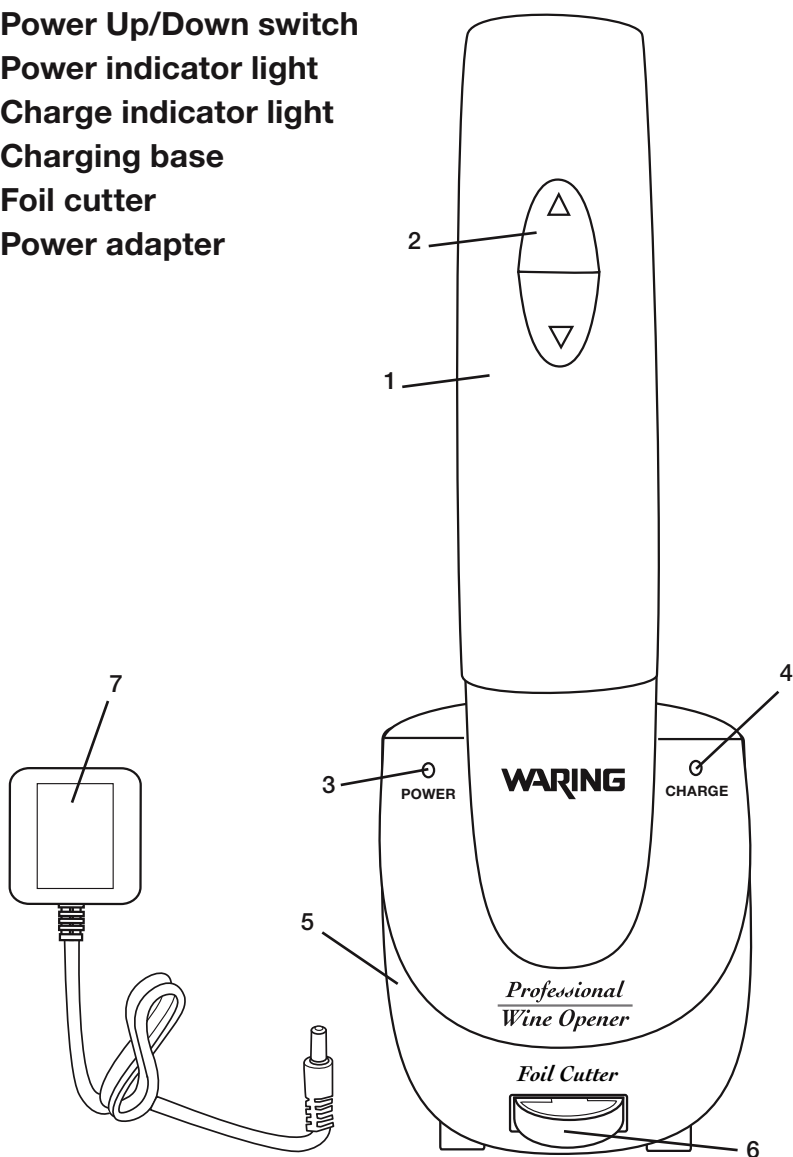

# OPERATING INSTRUCTIONS

## CONNECTION AND USE

We recommend that you charge your electric wine opener for at least eight hours before using for the first time. Please follow the instructions for recharging as stated below:

## RECHARGING YOUR ELECTRIC WINE OPENER

Plug one end of the adapter cord into the base of the recharging base and the other end into an electrical outlet. Place the electric wine opener into the recharging base, making sure that it is firmly in position and that it is fully engaged with the recharging connection. A green charge light will flash indicating that the unit is charging. It will take approximately 6-8 hours to recharge your electric wine opener. When your electric wine opener is fully recharged, the green light will stop flashing and become a solid green light.

Your wine opener can open approximately 80 bottles of wine on a full charge.

## FOIL CUTTER

For your convenience, this unit has a removable foil cutter, which is stored in the base of the unit.

Before removing the cork, you must remove any foil from the bottle (see fig 1). Attach foil cutter to the top of the wine bottle. Keep hand on lower part of bottle and turn foil cutter in twisting motion to remove foil. Remove foil to expose top part of cork surface.

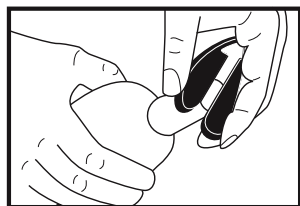

(fig 1)

**CAUTION:** Blade on foil cutter is sharp. Please keep fingers away from cutter's sharp edges.

## TO OPERATE YOUR WINE OPENER

Press the lower part of the switch (indicated by a down arrow) to remove a cork from the bottle. Press the upper part of the switch (indicated by an up arrow) to release a cork from the mechanism after you have removed the cork from the bottle (see fig 2).

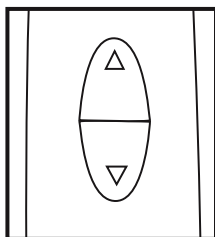

(fig 2)

1. Place the wine opener on top of the wine bottle making sure that it remains as straight/upright as possible at all times. If you hold the electric wine opener at an angle to the bottle it will not remove the cork properly (see fig. 3).

(fig 3)

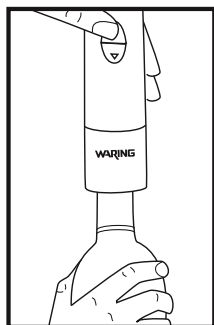

2. Hold the wine opener firmly and depress the lower part of the switch. The corkscrew spiral will turn in a counterclockwise direction and enter the cork, then gradually remove it from the bottle. When the electric wine mechanism has stopped, the cork has been fully removed from the bottle.

3. Lift the wine opener up and away from the bottle. To remove the cork, depress the upper part of the switch. The spiral will turn in a clockwise direction and release the cork (see fig 4).

(fig 4)

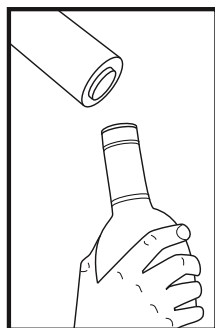

4. Always return the wine opener to the charging base when done. This will protect the unit while not in use.

©2008 Waring Products  
Division of Conair Corporation  
150 Milford Road  
East Windsor, NJ 08520

[www.waringproducts.com](http://www.waringproducts.com)

Printed in China  
WO50 IB  
08WR102

IB-8397